

# MTMC transitions from construction to relocation



AARON THOMPSON/DNJ

Everything from construction to landscaping at the new Middle Tennessee Medical Center, above, has been completed. All that remains is moving in equipment and acclimating staff to the new facility prior to an Oct. 2 opening.

## Summer to be spent getting ready for move

BY MELINDA HUDGINS  
MHUDGINS@DNJ.COM

The countdown is under way — and only 103 days remain before Middle Tennessee Medical Center opens the doors of its new \$267 million facility on Oct. 2.

Earlier this week, crews completed construction on the new facility and Turner Universal handed over the keys to MTMC administrators.

In just three short months, crews will install equipment and furniture, department heads will be trained and oriented, and patients will be transported from the current hospital on Highland Avenue to the new building on Medical Center Parkway.

It may sound like a lot of work, but the staff at MTMC has been working on its Move Strong initiative for more than a year, according to Steve Clevenger, director of medical imaging and radiation therapy, who is overseeing the transition.

Many of the patient beds and newer equipment will be transferred to the new facility.

"There is a team of people in charge of gathering the leftover (items), which will be categorized and shared with sister hospitals and community partners," he said, adding that local churches or centers may be able to use some of the medical equipment.

SEE MTMC, PAGE B9

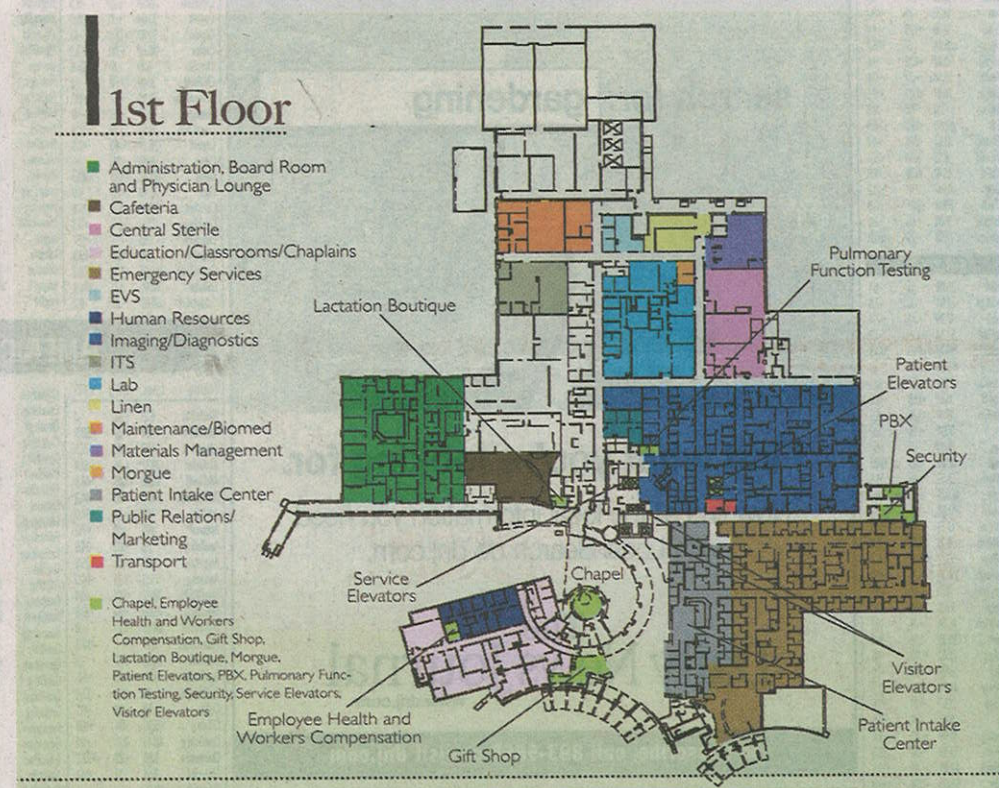

COURTESY OF MTMC

A color-coded floorplan details features found on the first floor of the new MTMC in Murfreesboro. Visit [www.dnj.com](http://www.dnj.com) to view additional floorplans.

## MTMC

FROM PAGE B7

A major initiative over the summer will acclimating hospital staff to the new facility's layout, which differs greatly from the existing building. The new MTMC is four times larger, allows for 61 additional patient beds and consistency on each floor to provide for a smooth workflow, according to data provided by the hospital.

Another crucial aspect of the preparation involves real-time test runs, which Clevenger has dubbed "Day In the Life" scenarios.

"There are five different scenarios that touch every department with the day-to-day interaction with a patient," he explained.

The staff is also working to determine when a Life-Flight practice run will be feasible. Currently, patients arriving by helicopter are transported from the helipad nearly a block away from the Highland Avenue hospital to the emergency room. At the new facility, the helipad is located just feet away from the ER doors.

Between Sept. 29 and Oct. 1, MTMC doctors will cease all elective surgeries to allow for the transition to move efficiently.

"By Monday, we should be able to operate as normal as possible," he said.

He explained that Rutherford County Emergency Medical Services has donated 15 ambulances to assist with the transportation of patients from the old hospital to the new hospital.

"We will begin at 5:30 a.m. on Oct. 2, and we hope to be done by 2 p.m.," Clevenger said.

The city of Murfreesboro is also working hand-in-hand with MTMC to coordinate the transportation of equipment and patients from the existing fa-

## MTMC-By the numbers

Facts about the new \$267 Middle Tennessee Medical Center:

- 68 acres at new site, compared to 18.73-acre Highland Avenue site

- 556,361 square feet, four times larger than current facility

- 286 patient rooms at 270 square feet; current hospital has 225 beds at 180 square feet

New rooms also include family zone in patient room with sofa and separate television; handicap-accessible bathroom in each patient room; floor-to-ceiling windows for maximum natural light

- n \$32 million in medical equipment

- n \$9 million - cost of all major equipment (mechanical, plumbing and electrical)

- n 3.9 million linear feet of electrical wiring, which is enough to stretch from Murfreesboro to Houston, Texas

- n 2.3 million square feet of drywall

- n 450,000 utility-sized bricks

- n 2.8 million construction crew work hours

- n 2,740 tons of steel

- n 1606 campus parking spaces

- n 8,100 shrubs

- n 953 trees

- n 11,000 light fixtures

- n 2016 doors

### Departments

- n Medical/Surgical Services: 211 beds (includes oncology, pediatric, medical and surgical patients)

- n Intensive and Critical Care Unit: 32 beds

- n Surgical Services: 12 operating rooms

- n Maternity Services: 27 post-partum rooms, 11 labor and delivery rooms, 16 neonatal intensive care beds

- n Emergency Services: 21,000 square feet, 41 all-private exam rooms

SOURCE: MIDDLE TENNESSEE MEDICAL CENTER

cility to the new hospital.

Both groups have been in discussion about the specifics of the move, which will involve routing traffic and possible police assistance, according to Murfreesboro transportation director Dana Richardson.

"We're just trying to do what we can to facilitate the move in the most safe and convenient manner possible," he said. "The main thing from our standpoint is trying to minimize the inconvenience to the

motoring public while the move is ongoing."

Of the Move Strong initiative, Clevenger says he feels confident that the staff will be prepared upon opening.

"I feel very good about it — we've got some great help from a team that is very engaged and, above all, we want to be safe and make sure that patients leave safely and are put into the correct room," he concluded.

— Melinda Hudgins,  
615-278-5131