

1st Floor

- Administration, Board Room
- Daily Bread Cafe
- Education/Classrooms/Chaplains
- Emergency Services
- Emergency Waiting Area
- Healing Grounds Coffee
- Human Resources
- Imaging/Diagnostics
- Lab
- Patient Intake Center
- Public Relations/Marketing
- Chapel, Gift Shop, Lactation Boutique, Security and Visitor Elevators

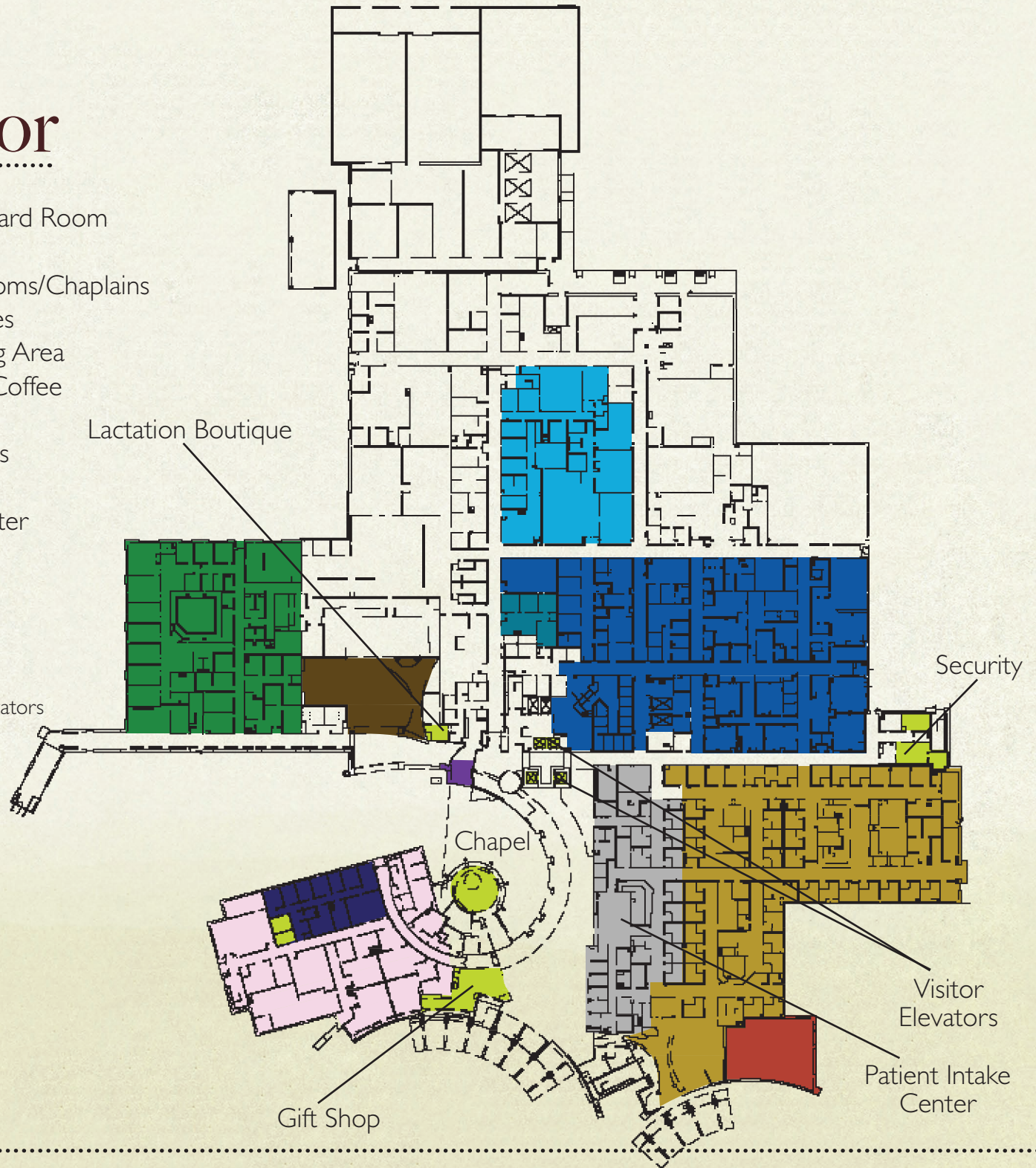

2nd Floor

- Critical Care
- Education, Medical Records, Finance
- Critical Care Family Waiting
- Same Day Services
- Surgery Waiting and Visitor Elevators

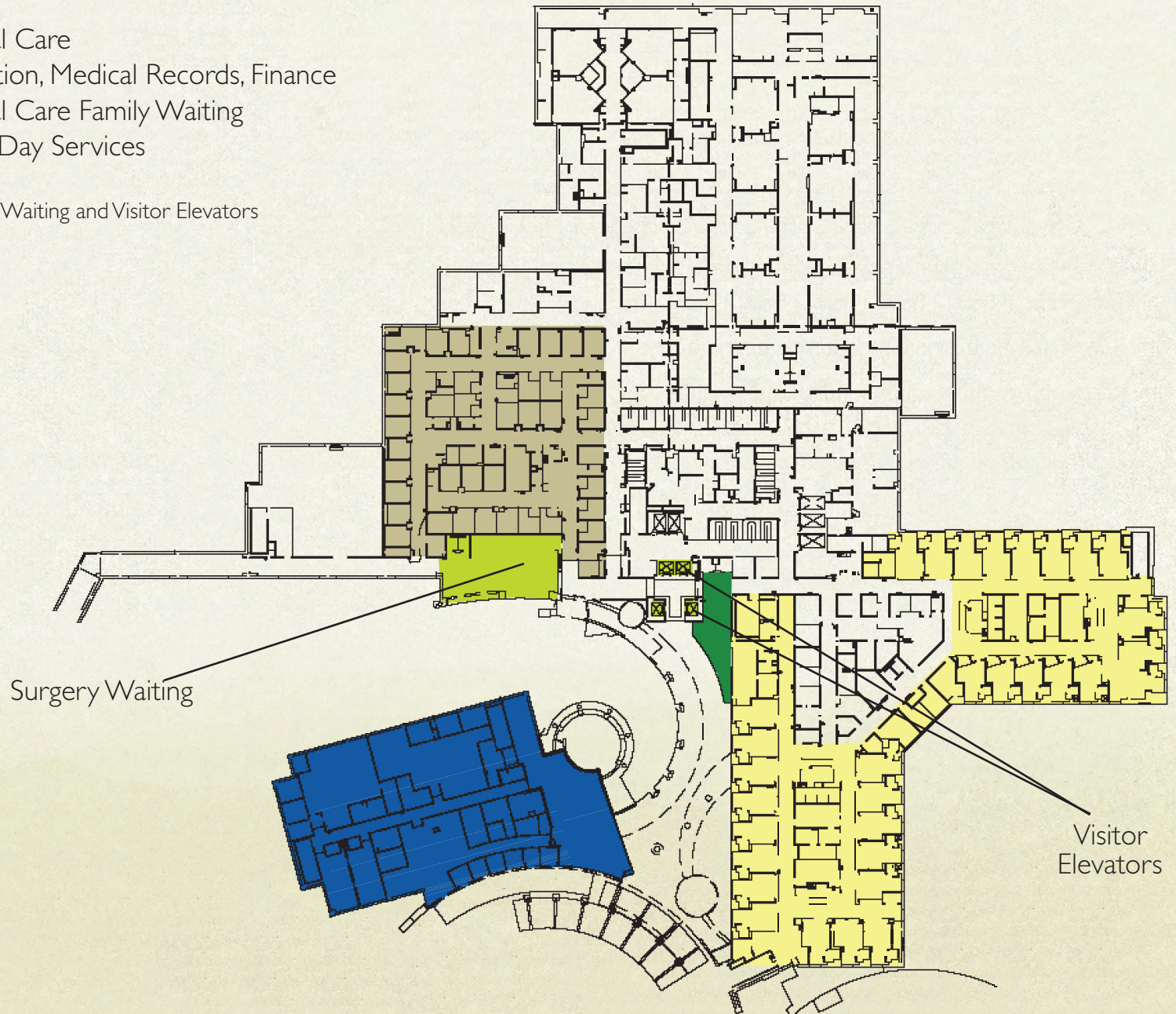

3rd Floor

- Labor & Delivery
- NICU
- Nursery
- OB Admission
- Postpartum
- Labor & Delivery Waiting

Newborn Photography and Visitor Elevators

Newborn Photography

Visitor Elevators

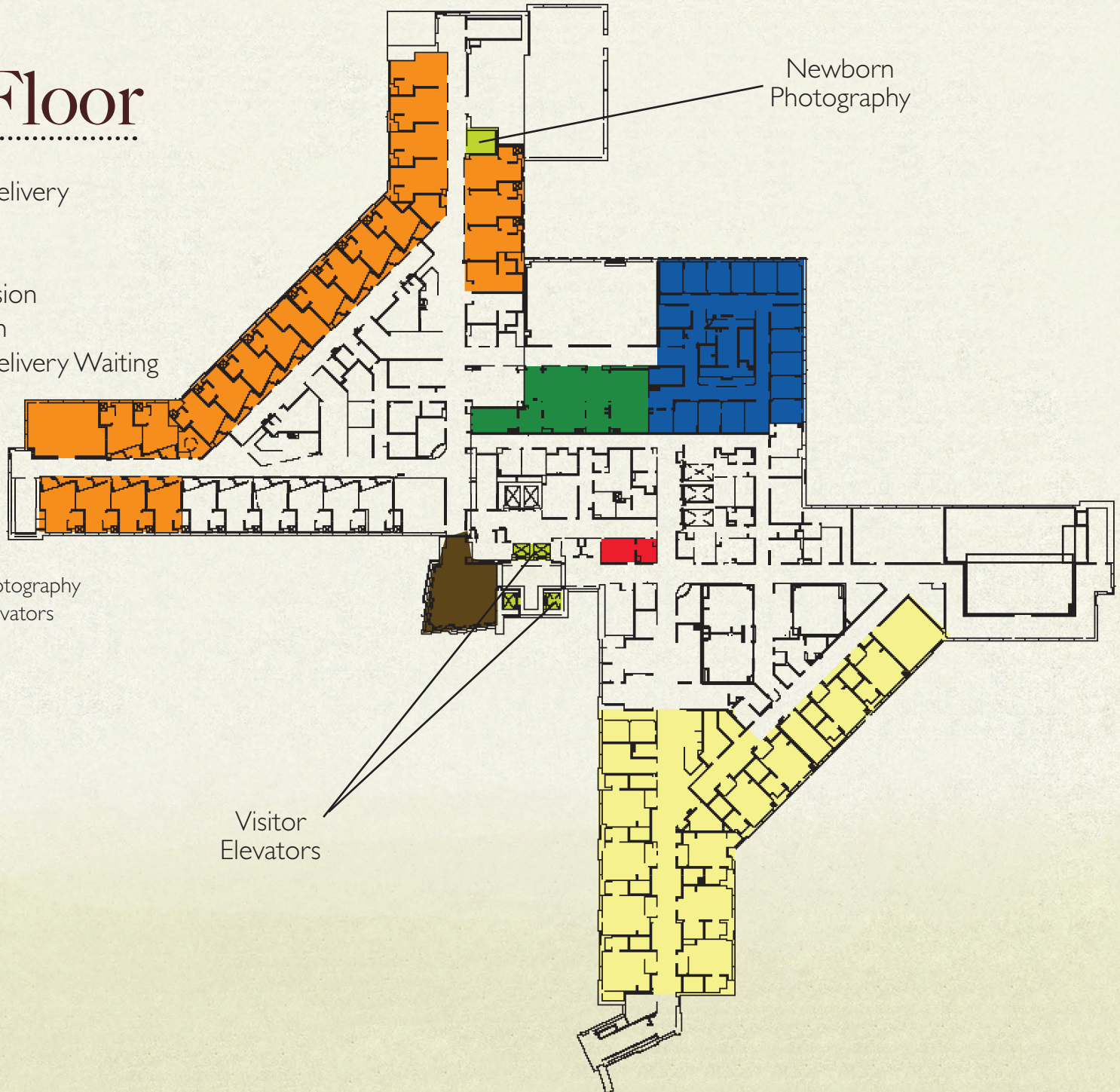

4th & 5th Floors

4th Floor

- East Tower = 404-436
- West Tower = 441-476
- Waiting Room

5th Floor

- East Tower = 503-536
- West Tower = 541-576
- Waiting Room

- Visitor Elevators

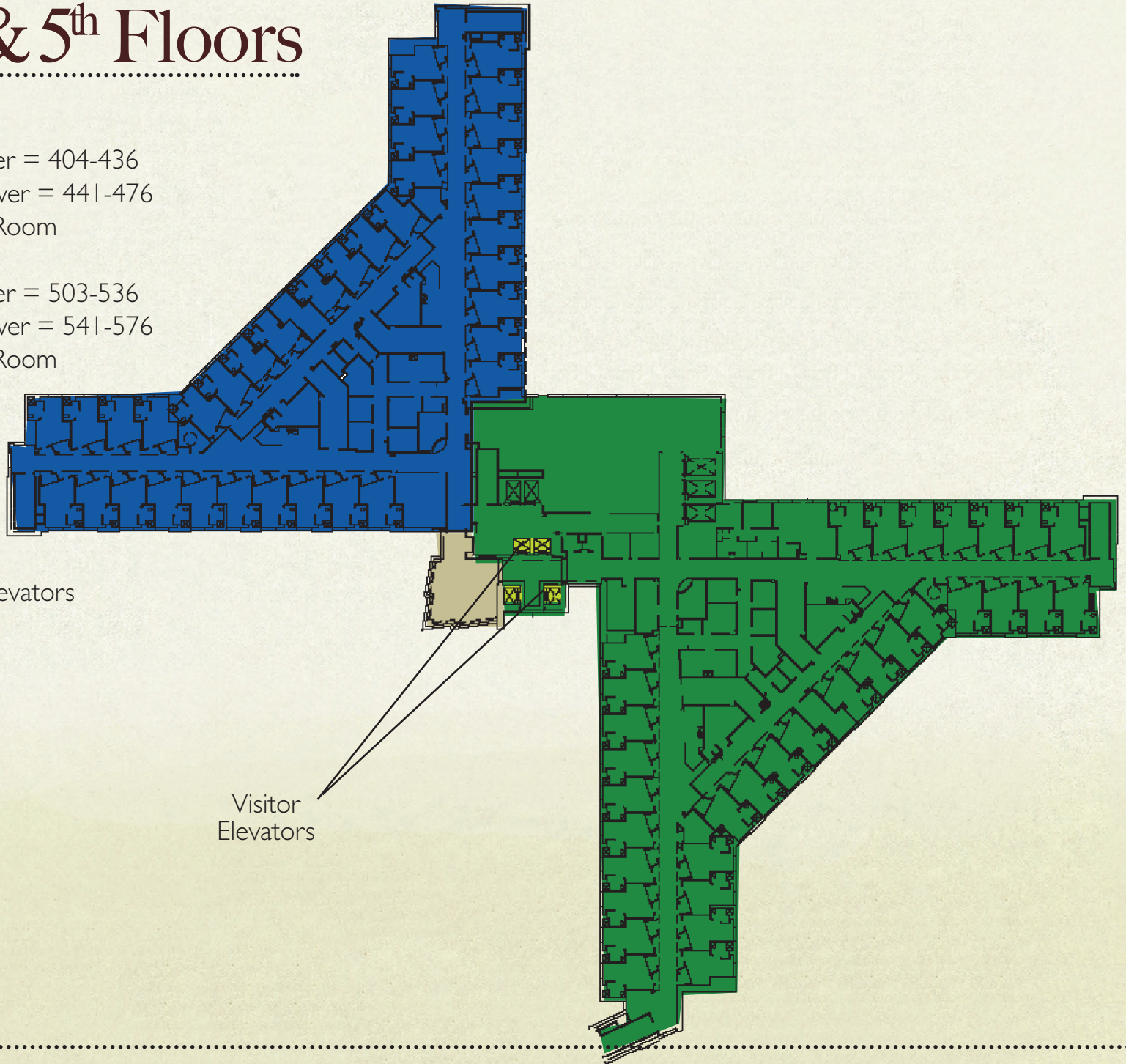

6th & 7th Floors

6th Floor

■ East Tower = 601-636

■ Waiting Room

7th Floor

■ East Tower = 701-736

■ Waiting Room

■ Visitor Elevators

Visitor
Elevators

